

Lever Handle Assembly Instructions

Simple Cylinder (For LM Lockcase)

Installation Steps ※Error made during installation may affect the cylinder lock

1. Check that the lockcase is NOT in the locked state.
2. Insert key supplied (teeth pointing upwards) into the cylinder.

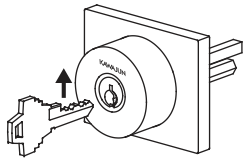

3. Turn the key 90° towards the direction of the door edge before inserting into the lockcase.

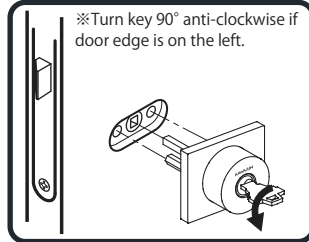
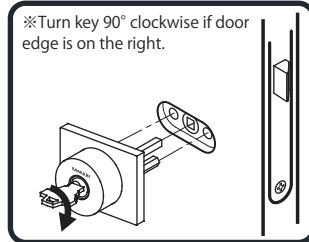

4. Secure metal base to door with screws provided.
(Over tightening of the screws may affect cylinder lock)
5. Fit the thumb turn base to the metal base with the thumb turn positioned vertically. Rotate plastic base clockwise to secure thumb turn to metal base.
6. Before attaching the cover, check that the key is able to lock and unlock smoothly.

