

Door Bumper Installation Instruction Sheet

※ Please read the installation instruction before installing.
Please do not dispose of the installation sheet after installation,
instead please pass it to the product user for safe keeping. AC-590/591

■ For Wall Installation

- ① Install the connector with the screws provided.
- ② Screw the body of the bumper onto the connector.

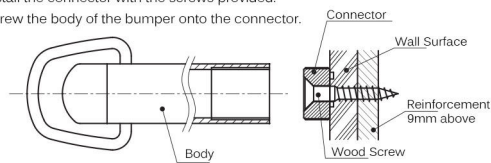

■ Dimension

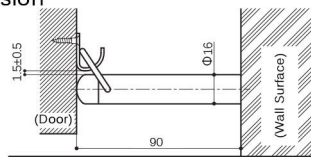

● Hook Installation

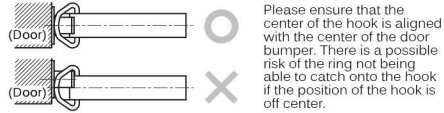

⚠ Regarding Product Usage & Maintenance

- To ensure proper installation of the connector and hook, please ensure that installation is made on reinforced walls or doors surface. (Please do not install the product on plaster walls.)
- A damp cloth with mild detergent (5-10% dilution) will be sufficient for maintenance. Do not use gasoline (benzin), thinner, alcohol or alkali-based detergent and cleanser to clean the products.
- Please install the door bumper to hit the surface that can accept more force.

NO. 003